

METRIC CABLE GLANDS



Material

Body: PA 6 (Poyamide 6)
 Cap: PA 6 (Polamide 6)
 Seal: CR (Chloroprene Rubber)

Flammability

V2 (According to UL 94)

Protection Class

IP68 - 5 Bar (72.5 psi)

Operating Temperature

Permanent: -20°C to +100°C (-4°F to +212°F)
 Intermittent: -30°C to +150°C (-22°F to +302°F)

Thread

ANSI B 1.20.1

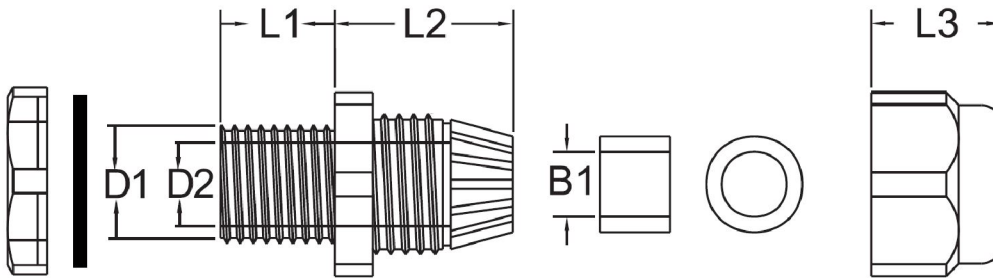

Metric Gland Specs (mm)

	D1	D2	B1	L1	L2	L3	Cable Range	Units/Bag
M12	7.6	11.9	6.4	8.3	21.3	14.7	3-6.5	50
M16	11.3	15.8	8.8	8.3	22.4	14.7	4-8	50
M20	15.1	19.8	12.0	9.1	24.4	17.5	6-12	50
M25	19.6	24.9	18.3	10.4	30.0	23.2	13-18	50
M32	25.9	32.0	21.0	12.2	30.0	20.9	12-21	25
M40	33.8	40.1	31.5	15.5	39.0	30.1	22-32	10
M50	43.4	49.7	39.9	14.2	42.5	31.5	32-38	10